

Dishwasher

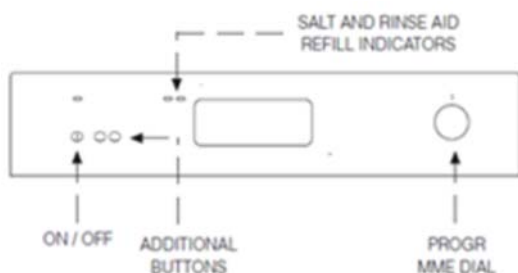

IMPORTANT

When you have loaded the dishwasher, make sure the sprinklers can spin freely and that the cutlery will not prevent the detergent tank cap from opening.

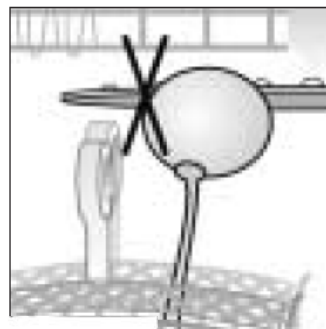

To select the wash programme proceed as follows:

a Select the wash programme.

b Press the **ON/OFF** switch.

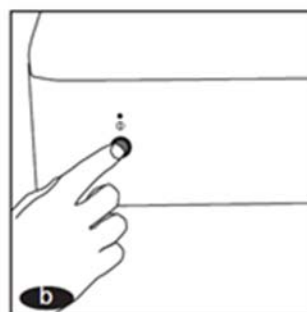
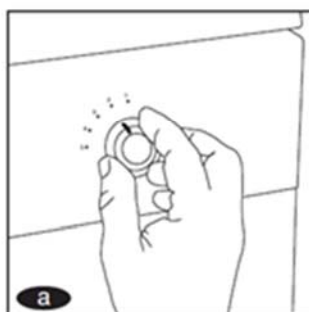



PROGRAMME TABLE - 5-BUTTON MODEL

DIAL POSITION	ADDITIONAL BUTTONS	PROGRAMME TYPE	TEMPERATURE °C	TYPE OF DISHES	AMOUNT of DETERGENT (grs.)
1	-	Prewash	Cold	For dishes not to be washed immediately	No detergent
2		Intensive	65	For very dirty dishes and pans	25 + 15
3*	-	Normal	55	For very dirty dishes and pans	25 + 5
4	e	Economy	55	For slightly dirty dishes	25 + 5
4		Delicate	45	Special glass	25
5	-	Quick wash	55	For very slightly dirty dishes	25

* Programme 3 is standardised in accordance with EN-50242

If the dishwasher is functioning and...

- You wish to add another dish.
- You wish to change the wash programme.

1. Press the On / Off button. 
2. Place the dish in the dishwasher and/or change the wash programme. 
3. Press the On / Off button.

NOTE: For safety reasons the programme will restart after a few seconds.

IMPORTANT

Do not open the dishwasher door during the washing process. This could interfere with the programme phases.

How to clean the filter and the sprinklers

The filter is made up of two or three parts (depending on model type): interior filter, exterior filter and filter protector. It is located at the bottom of the dishwasher under the bottom rack.

- a** Take out the bottom rack, remove the interior filter by turning it anticlockwise and pulling it upwards.
- b** Remove the exterior filter.
- c** Remove the filter protector (some models).
- d** It is essential that filters are put back in place correctly. Make sure the filter protector is in place. The exterior filter fits into position. Put the interior filter in position and turn it clockwise as far as it will go.

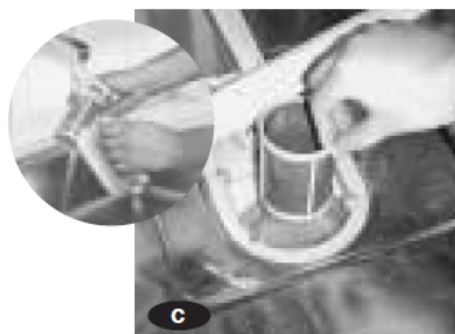
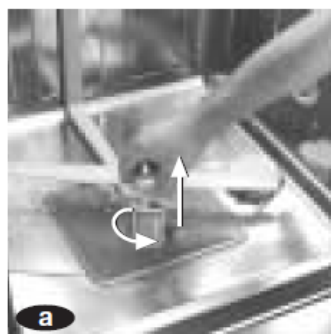

The third sprinkler (depending on the model), the top sprinkler and the bottom sprinkler should be cleaned every three months. To remove the sprinklers for cleaning:

- a** The third sprinkler is removed by pressing upwards on it and then unscrewing it.
- b** The top sprinkler is fitted to the top basket. It should be totally unscrewed to remove it.
- c** The bottom sprinkler is removed by turning the lower screw to the left to loosen it and then pulling upwards on the sprinkler.

Rinse the sprinklers under the tap and clean them with a non-scratch sponge.

The water outlet holes must be kept clean. Unblock any holes that are obstructed. Then put the sprinklers back.

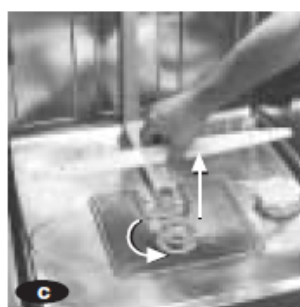
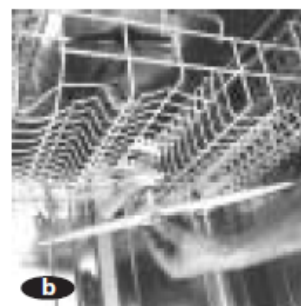

IMPORTANT

Before any cleaning or maintenance operations, **unplug the dishwasher from the mains.**